

20mm Timber Thermal Batten

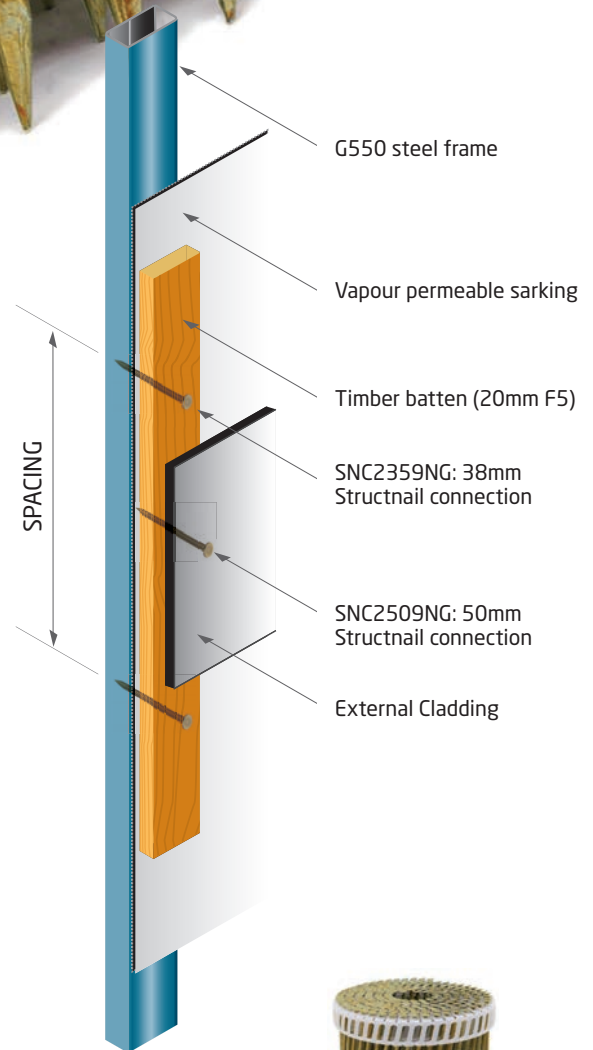

SNC2359NG FIXING MATRIX		NAIL SPACING	
BMT	Stud Centre	General (0.86kPa)	1200 from edge (1.30kPa)
0.55 - 0.95	450mm Centres	Nominal 800mm Centres	
	600mm Centres		

NOTES:

1. Use SNC2359NG to connect the timber batten to the steel frame
2. Use SNC2509NG to install cladding system through the timber batten use preferred fixings to install external cladding
3. Refer to Cladding manufacturer for cladding nailing fixing spacings
4. Gun nailing based on air pressure range of 90-110 psi and pneumatically driven, not by hammer.
5. The information in this brochure is suitable for use only in Non Cyclonic regions as defined by AS4055:2012. Buildings must conform with limitations set by this standard and any deviation from this to be approved by a suitably qualified engineer.
6. Batten must be located directly in line with stud behind and nail to be installed within half of stud flange closer to web.
7. Nails should be evenly spaced along batten with a nail located 20mm from end of batten. Battens should be minimum 2 span

GRIPSHANK™ SUPERSHARPY™



Part No.	Description	mm	mm	mm	qty	qty
SNC2359NG	Gripshank™ Supersharpy™ 38x2.5	38	2.5	6.4	3200	n/a
SNC2509NG	Gripshank™ Supersharpy™ 50x2.5	50	2.5	6.4	2400	n/a